

SITUATIA EXISTENTA sc. 1:1000

SUPRAFATA STUDIATA

| Nr. Pct. | Coordonate pct.de contur | Lungimi laterali D(i,i+1) |
|----------|--------------------------|---------------------------|
| | X [m] Y [m] | |
| 15 | 378544.53 585858.76 | 60.38 |
| 12 | 378493.99 585891.70 | 100.09 |
| 13 | 378424.86 585936.86 | 13.47 |
| 14 | 378419.76 585924.05 | 70.00 |
| 3 | 378461.58 585896.98 | 209.77 |
| 4 | 378296.63 585767.38 | 14.75 |
| 5 | 378301.37 585753.41 | 12.39 |
| 6 | 378312.84 585758.09 | 43.39 |
| 7 | 378353.20 585774.02 | 28.29 |
| 8 | 378378.96 585785.71 | 9.40 |
| 9 | 378387.65 585789.30 | 16.74 |
| 21 | 378403.24 585795.40 | 24.77 |
| 20 | 378426.29 585804.46 | 33.88 |
| 19 | 378458.33 585815.48 | 14.71 |
| 18 | 378472.45 585819.61 | 30.93 |
| 17 | 378500.56 585832.51 | 40.00 |
| 16 | 378537.84 585847.01 | 13.52 |

SUPRAFATA=12983mp

SUPRAFATA PROPUSA PENTRU INTRODUCERE IN INTRAVILAN

| Nr. Pct. | Coordonate pct.de contur | Lungimi laterali D(i,i+1) |
|----------|--------------------------|---------------------------|
| | X [m] Y [m] | |
| 1 | 378486.80 585880.73 | 18.40 |
| 2 | 378471.33 585890.69 | 11.60 |
| 3 | 378461.58 585896.98 | 209.77 |
| 4 | 378296.63 585767.38 | 14.75 |
| 5 | 378301.37 585753.41 | 12.39 |
| 6 | 378312.84 585758.09 | 43.39 |
| 7 | 378353.20 585774.02 | 28.29 |
| 8 | 378378.96 585785.71 | 9.40 |
| 9 | 378387.65 585789.30 | 11.21 |
| 10 | 378384.42 585800.03 | 130.36 |

SUPRAFATA=6090mp

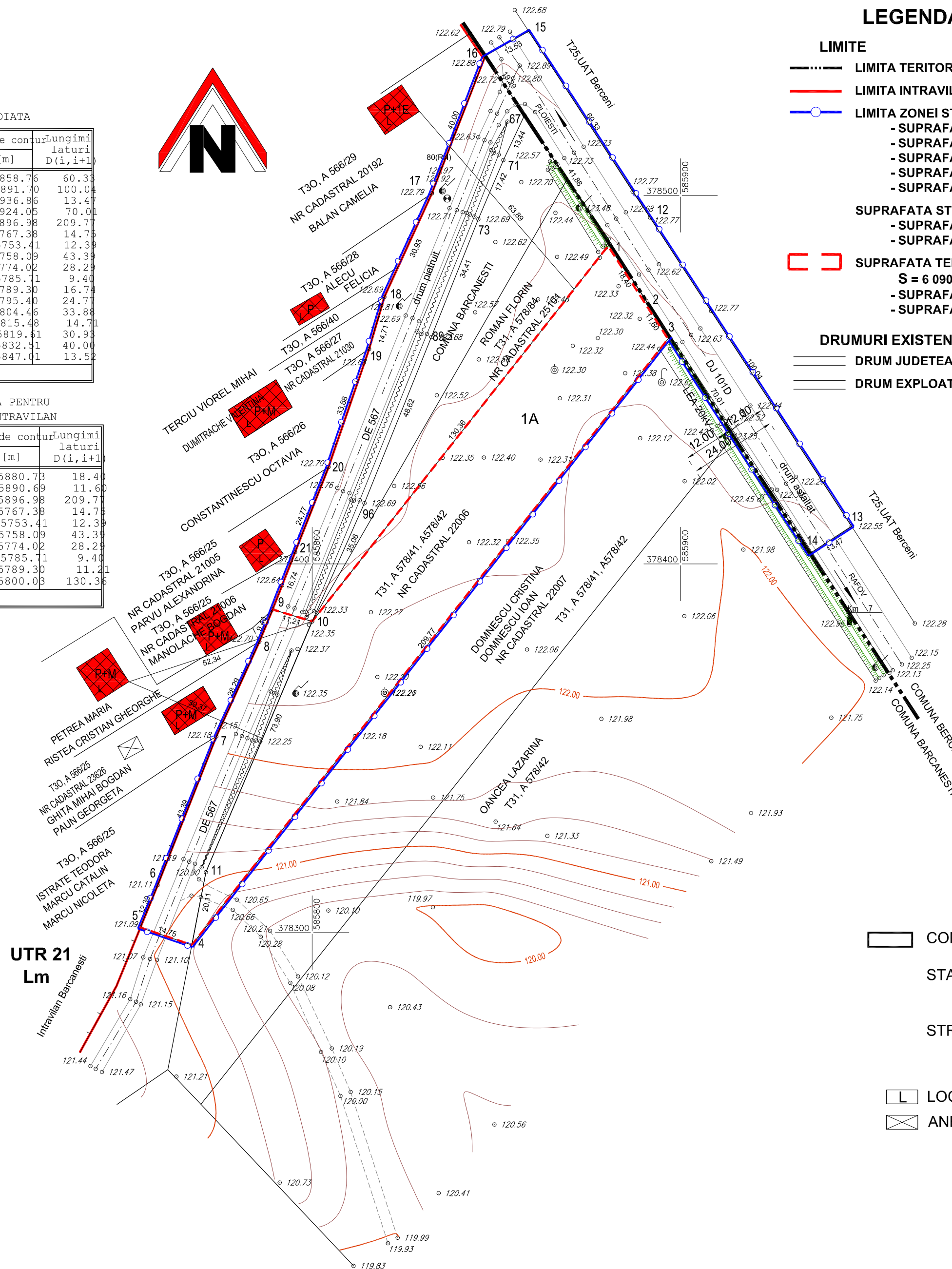
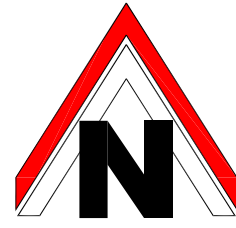

LEGENDA:

LIMITE

- LIMITA TERITORIU ADMINISTRATIV
- LIMITA INTRAVILAN EXISTENT APROBAT
- LIMITA ZONEI STUDIATE: S = 12 983,00 mp din care:
 - SUPRAFATA DRUM De 567: S = 3 249,00 mp
 - SUPRAFATA DRUM DJ 101D: S = 2 143,00 mp
 - SUPRAFATA propr. ROMAN FLORIN nr. cad. 22006: S = 5 000,00 mp
 - SUPRAFATA propr. ROMAN FLORIN nr. cad. 25101: S = 1 300,00 mp
 - SUPRAFATA EXTRAVILAN com. BARCANESTI: S = 1 291,00 mp
- SUPRAFATA STUDIATA S = 12 983 mp din care:
 - SUPRAFATA EXTRAVILAN com. BARCANESTI: S = 10 841,00 mp
 - SUPRAFATA EXTRAVILAN com. BERCENI: S = 2 142,00 mp
- SUPRAFATA TEREN PROPUSA PENTRU INTRODUCERE IN INTRAVILAN S = 6 090,00 mp din care:
 - SUPRAFATA DRUM De 567: S = 1 090,00 mp
 - SUPRAFATA propr. ROMAN FLORIN nr. cad. 22006: S = 5 000,00 mp

DRUMURI EXISTENTE:

- DRUM JUDETEAN DJ 101D
- DRUM EXPLOATARE De 567

CONSTRUCTII EXISTENTE

- STARE:
- BUNA
 - MIEDOCRA
 - REA
- STRUCTURA:
- ▨ DURABILA
 - ▨ SEMIDURABILA
 - ▨ NEDURABILA

- LOCUINTE
- ANEXE

| | | | | | |
|---|-------------------------|-----------|-------------------|---|----------------------|
| S.C. ARHIPROIECT S.R.L. PLOIESTI, str. Zefirului, nr. 21 Reg.Com. J29/204/2004, CUI: 16098020 | | | | Beneficiar: ROMAN FLORIN | Pr. nr. 11 / 2013 |
| SPECIFICATIE | NUME | SEMNATURA | SCARA: 1:1 000 | Extindere intravilan pentru zona locuinte si functiuni complementare, zona spatii verzi-perdele de protectie si zona mixta cai de comunicatii rutiere si dotari aferente si institutii si servicii Jud. Prahova, com. Barcanesti, sat Ghighiu | FAZA: P.U.Z. |
| SEF PROIECT | Arh. Adriana Constantin | | | | |
| PROIECTAT | Arh. Adriana Constantin | | DATA: 06.2014 | | PLANSA A4 |
| DESENAT | Tch. Danescu Angela | | | SITUATIA EXISTENTA | |